



HMD 26-II
HME 26-II
HMD 26-II-600-S

Quick Guide
 Kurzanleitung
 Guide de démarrage rapide
 Guida rapida
 Instrucciones resumidas
 Instruções resumidas
 Beknopte gebruiksaanwijzing
 Krótka instrukcja obsługi
 Snabbguide

Kort vejledning
 Pikaohje
 Σύντομες οδηγίες
 Kısa Kılavuz
 Краткая инструкция
 快速指南
 快速使用指南
 クイックガイド
 요약 안내서

SENNHEISER

In the box

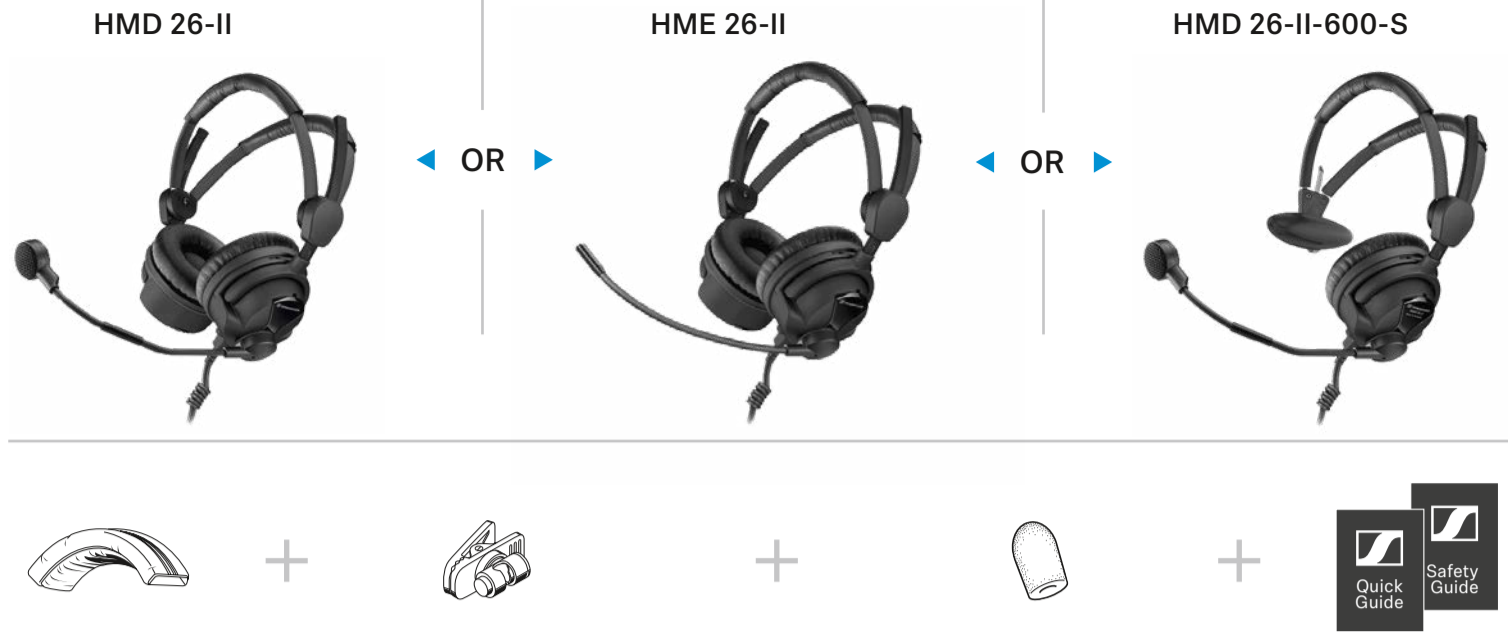

Switching ActiveGard™

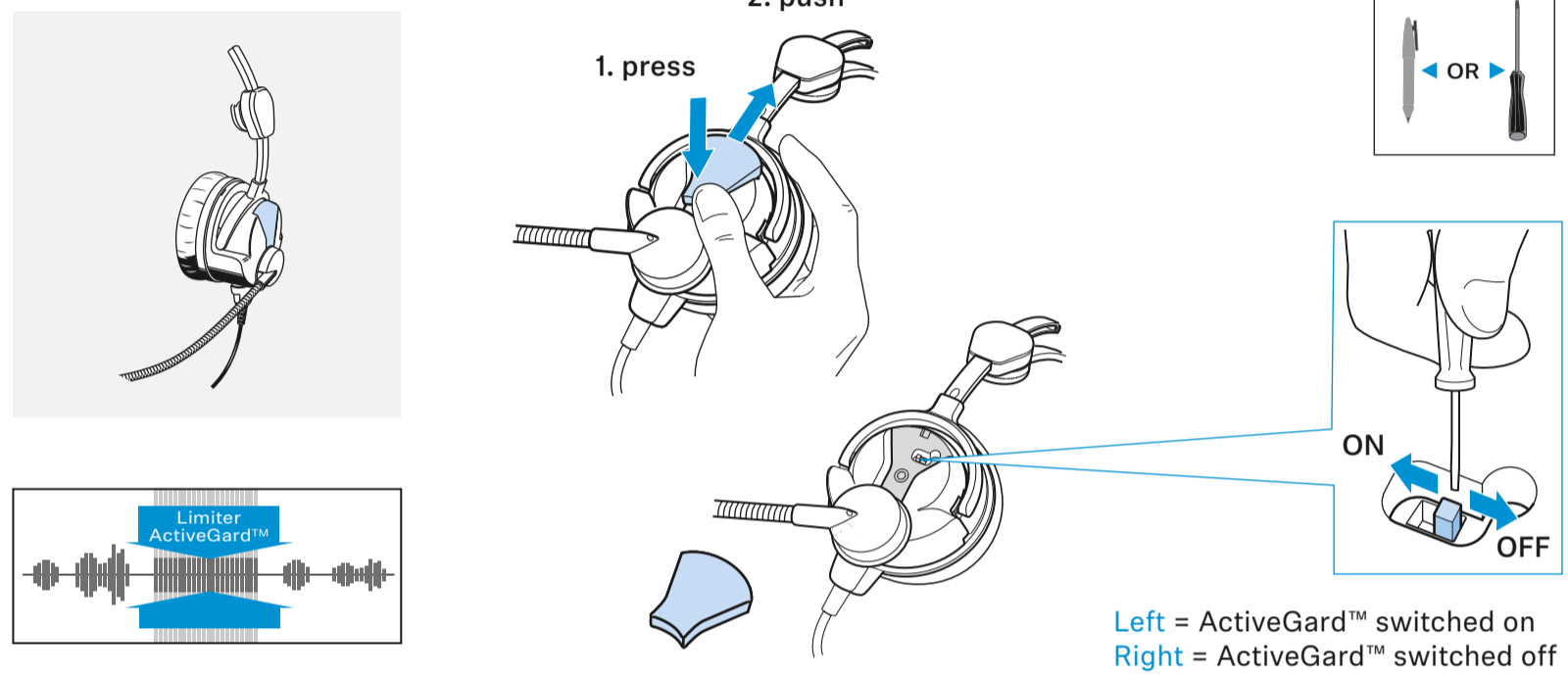

Sennheiser electronic GmbH & Co. KG
 Am Labor 1, 30900 Wedemark, Germany
 www.sennheiser.com
 Printed in Germany, Publ. 07/22, 592833/A02

Wearing the headset

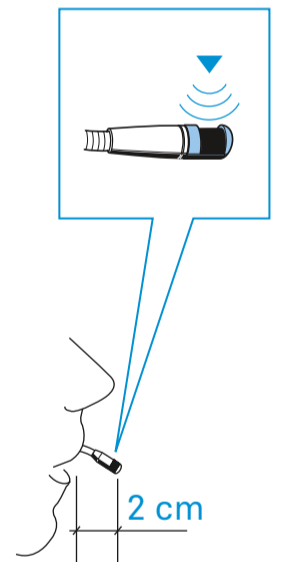
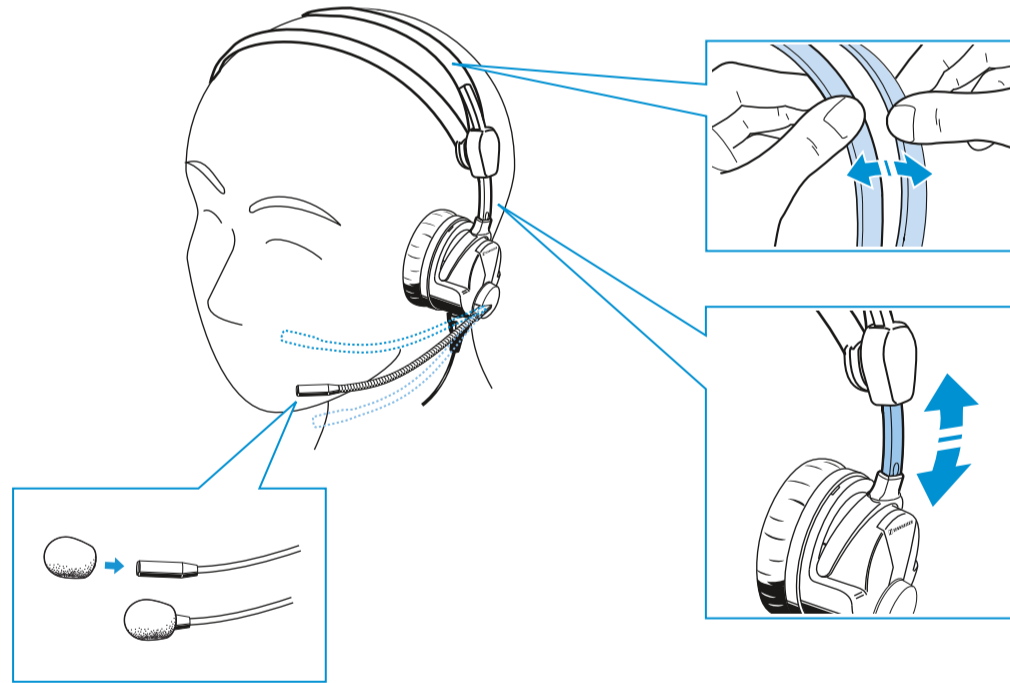
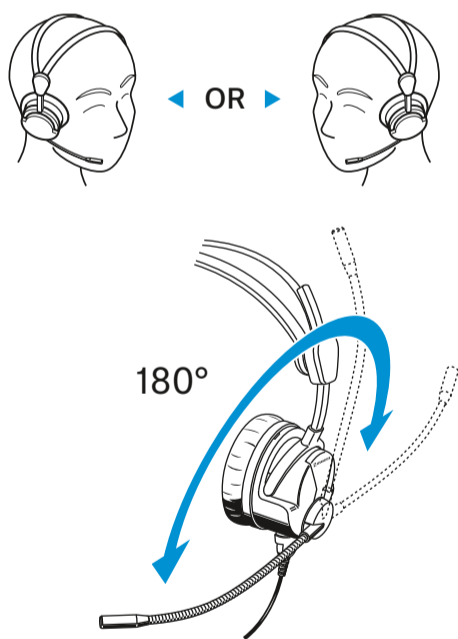

Single-sided listening

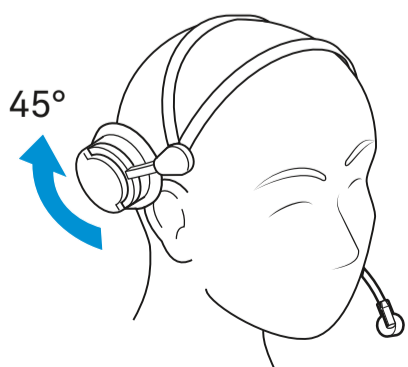

Replacing the ear pads

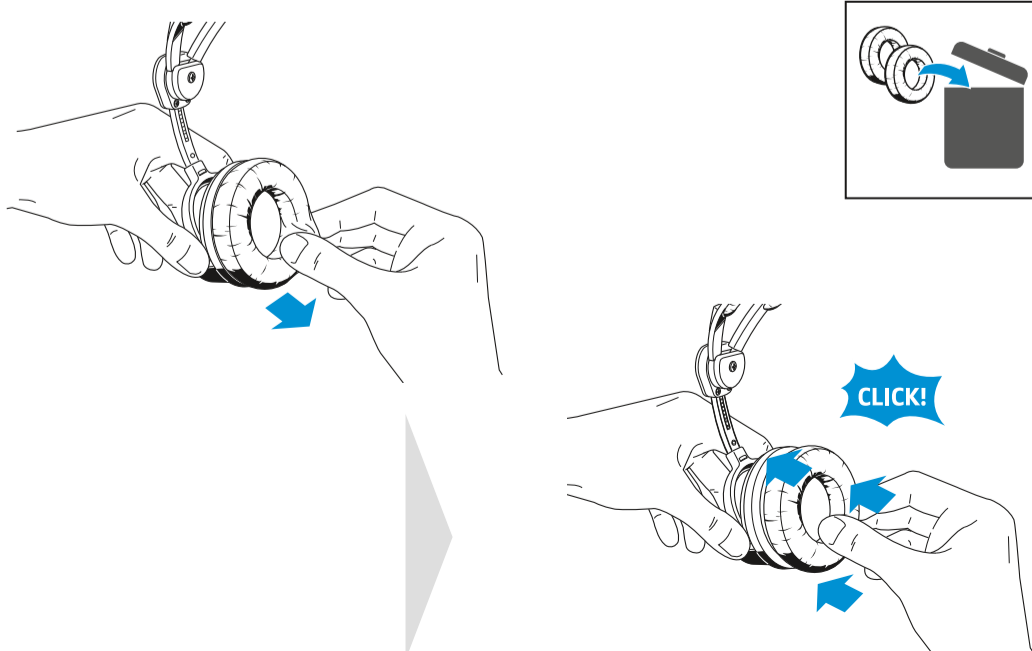

Accessories

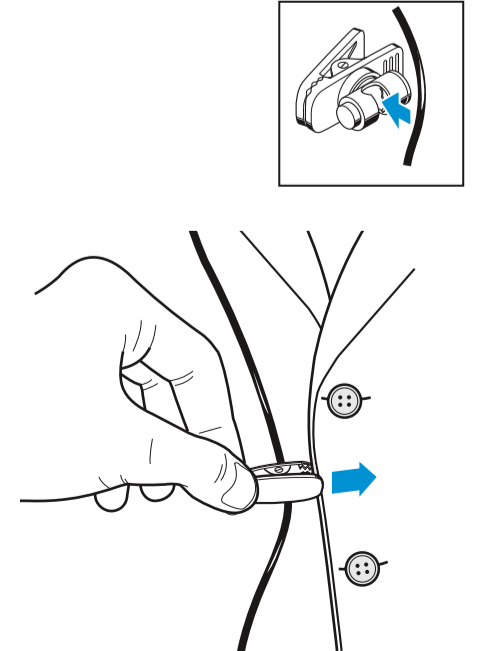

Replacing the headband

Wearing with large headband padding

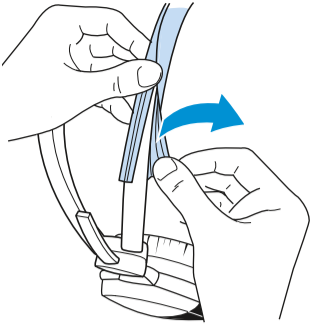

1 Remove both small headbands.

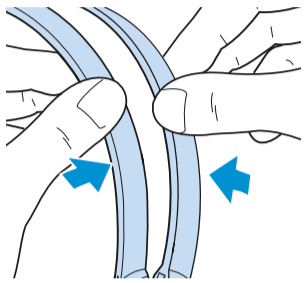

2 Collapse the split headband.

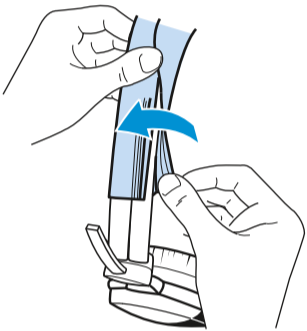

3 Mount the large headband padding.

Wearing with small headbands

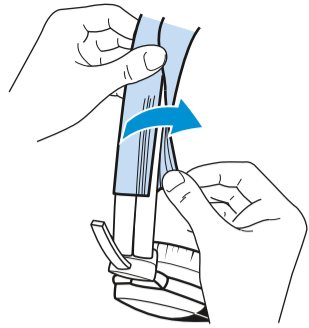

1 Peel off the large headband padding.

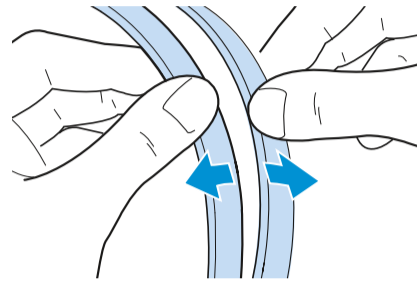

2 Pull the headband carefully apart.

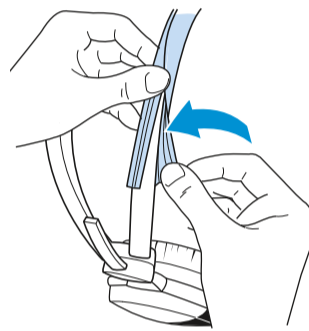

2 Mount the small headbands.

Cleaning

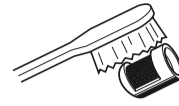

CLICK!

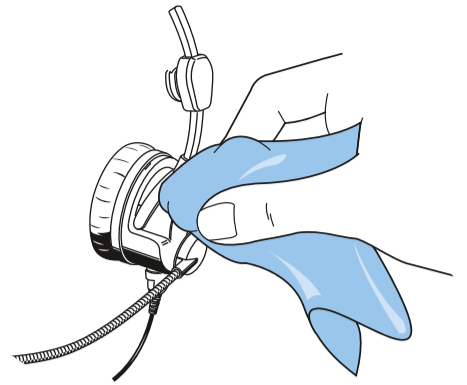

Specifications

HMD series

Headphones	HMD 26-II-600	HMD 26-II-600S	HMD 26-II-100
Transducer principle	dynamic, closed		
Ear coupling	supra-aural		
Frequency response	20 to 18,000 Hz		
Impedance	300 Ω mono/ 600 Ω stereo	600 Ω mono	50 Ω mono/ 100 Ω stereo
Characteristic SPL ActiveGard™	105 dB SPL at 1 kHz, 1 mW		
switched on:	105 dB SPL at 1 kHz, 1 mW		
switched off:	107 dB SPL at 1 kHz, 1 V	115 dB SPL at 1 kHz, 1 V	
Max. SPL ActiveGard™	105 dB SPL at 1 kHz, 1 mW		
switched on:	105 dB SPL at 1 kHz, 1 mW		
switched off:	127 dB SPL at 1 kHz, 200 mW	128 dB SPL at 1 kHz, 200 mW	
THD	< 0,5 % at 1 kHz		
Contact pressure	approx. 3.9 N	approx. 4.0 N	approx. 3.9 N

Microphone

Type	BMD 424
Transducer principle	dynamic, noise-compensating, super-cardioid
Frequency response	40 to 16,000 Hz
Output voltage	0.4 mV/Pa at 1 kHz
Impedance	300 Ω

General data

Temperature range operation:	-15 °C to 55 °C		
storage:	-55 °C to 70 °C		
Weight without cable	approx. 200 g	approx. 130 g	approx. 200 g

HME series

Headphones	HME 26-II-600 HME 26-II-600(4)*	HME 26-II-100 HME 26-II-100(4)*-P48
Transducer principle	dynamic, closed	
Ear coupling	supra-aural	
Frequency response	20 to 18,000 Hz	
Impedance	300 Ω mono/ 600 Ω stereo	50 Ω mono/ 100 Ω stereo
Characteristic SPL ActiveGard™	105 dB SPL at 1 kHz, 1 mW	
switched on:	105 dB SPL at 1 kHz, 1 mW	
switched off:	107 dB SPL at 1 kHz, 1 V	115 dB SPL at 1 kHz, 1 V
Max. SPL ActiveGard™	105 dB SPL at 1 kHz, 1 mW	
switched on:	105 dB SPL at 1 kHz, 1 mW	
switched off:	127 dB SPL at 1 kHz, 200 mW	128 dB SPL at 1 kHz, 200 mW
THD	< 0.5 % at 1 kHz	
Contact pressure	approx. 3.9 N	

Microphone

Type	BKE 4-2 BKE 4-4 - only in variants (*4)
Transducer principle	BKE 4-2: pre-polarized condenser microphone, omni-directional BKE 4-4: pre-polarized condenser microphone, cardioid
Frequency response	40 to 20,000 Hz
Output voltage	4 mV/Pa ± 2.5 dB
Terminating impedance	min. 4.7 kΩ
Max SPL	150 dB at 1 kHz, 0.5% THD
Supply Voltage	5 to 15 V DC

General data

Temperature range operation:	-15 °C to 55 °C	
storage:	-55 °C to 70 °C	
Weight without cable	approx. 200 g	