



# MM 445



- Quick Guide
- Kurzanleitung
- Guide de démarrage rapide
- Guía rápida
- Instrucciones resumidas
- Instruções resumidas
- Beknopte gebruiksaanwijzing
- Krótká instrukcja obsługi
- Snabbguide
- Kort vejledning
- Pikaohje
- Γρήγορος οδηγός
- Kısa Kılavuz
- Краткая инструкция
- 快速指南
- 快速使用指南
- クイックガイド
- 퀵 가이드

Sennheiser electronic GmbH & Co. KG

Am Labor 1, 30900 Wedemark, Germany  
www.sennheiser.com

Printed in Germany  
Publ. 02/21, 583916/A03

## SENNHEISER

### Setup

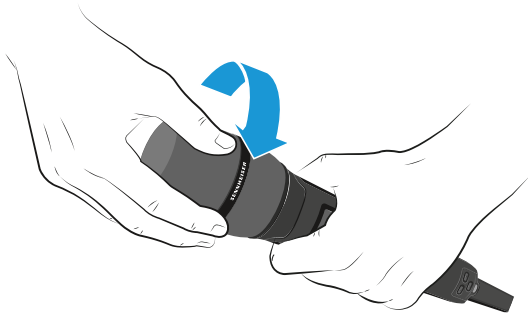
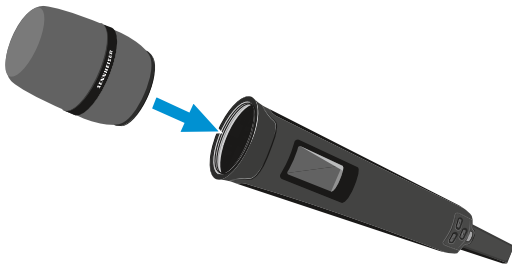

### In the box

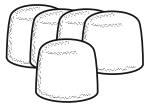
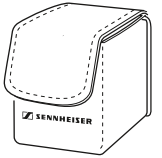

1 x Protective cap

5 x Pop shield

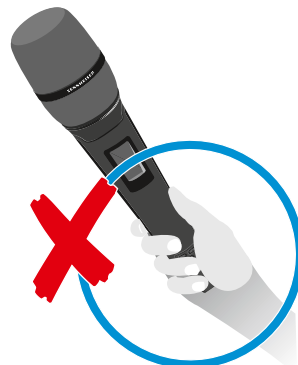
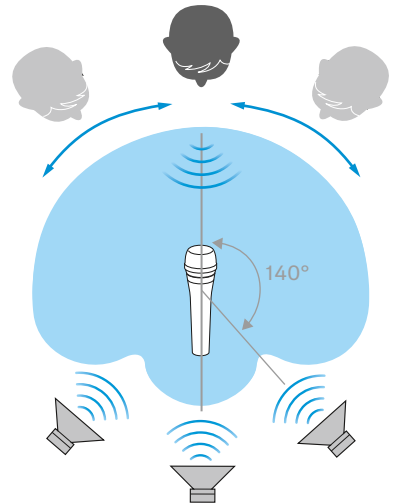

## Accessories



MZW 4032 / MZW 1

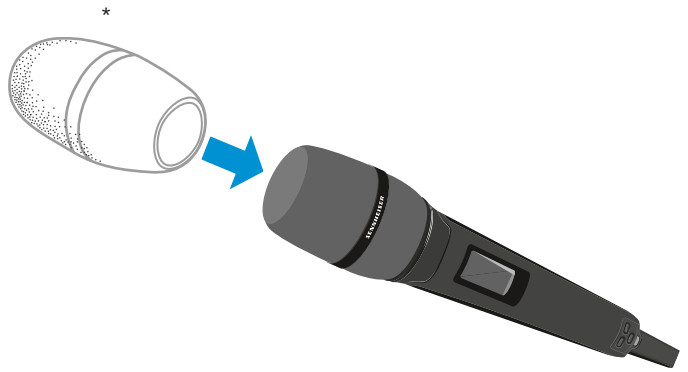
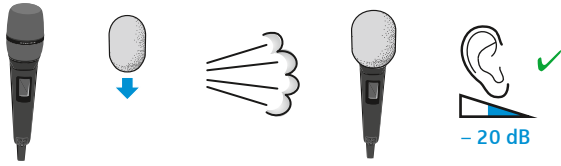

\*MZW 4032 / MZW 1 not included

## Cleaning

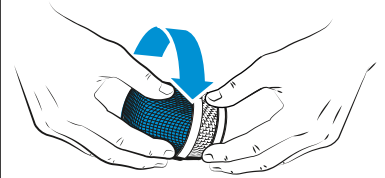
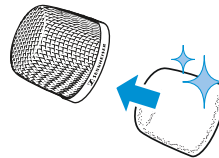
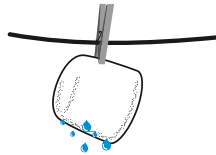
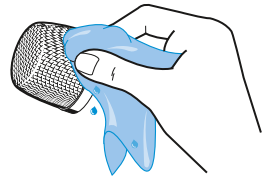
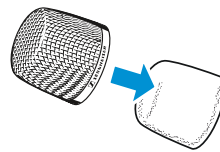
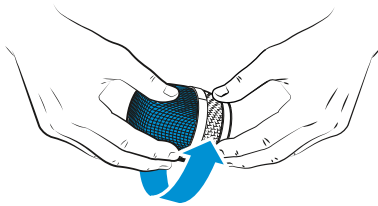

## Specifications

Transducer principle	dynamic
Frequency response	40 - 20,000 Hz
Pick-up pattern	high rejection supercardioid
Sensitivity (free field, at 1 kHz)	1.6 mV/Pa
Max SPL at 1 kHz	163 dB
Dynamic range	145 db (A)
Dimensions	∅ 51 x 67.5 mm
Weight	114 g

## Compatible with

ew G4:	SKM 300, SKM 500
2000 series:	SKM 2000
Digital 6000:	SKM 6000
Digital 9000:	SKM 9000

## Polar pattern and frequency response

